

- 1. S. 68 W. 65.0 post
- 2. S 14 E 35.0 Beech
- 3. S 88 E 18.0 Maple
- 4. N 75 E 22.0 Spruce
- 5. N 43 E 18.0 Pine
- 6. N 15 E 6.0 Dead Pine
- 7. N 2 1/4 W 34.3 No. Beginning

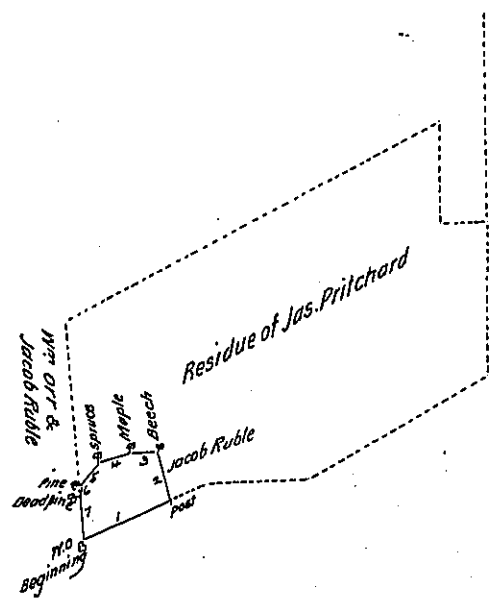

	N.	S.	E.	W.	M. Dist	N. Area	S. Area	
1	S. 68 W. 65.0	—	—	60.27	60.27 00.00	—	1467.5745	
2	S 14 E 35.0	—	33.96	8.47	8.47 18.94	—	287.6412	
3	S 88 E 18.0	—	0.63	17.99	34.83 52.92	—	22.0059	
4	N 75 E 22.0	5.78	—	21.25	74.17 95.42	422.7620	—	
5	N 43 E 18.0	13.16	—	12.28	107.78 119.98	1417.3320	—	
6	N 15 E 6.0	5.80	—	1.55	121.53 123.04	704.8740	—	
7	N 2 1/4 W 34.3	34.28	—	—	121.81 020.54	4175.6468	—	
					58.94	58.94	61.64	61.54
					121.53	520	97.2240	827.55
					704.8740	121.81	3428	974.78
					24.362	487.24	36.543	4175.6468
					106	8730	844	—
					1777.2216	1777.2216	—	—
					4120.4002	4120.4002	—	—
					163.6	2471.7001	149.91	—

60.27
24.35
301.35
18061
241.08
120.54
1467.5745

33.96
8.47
237.72
13.554
271.68
287.6412

3493
63
10479
20958
22,0059

74.17
570
513790
37085
4227690

107.70
18.16
64220
10770
31310
10790
17173320

121.53
520
97.2240
827.55
704.8740

121.81
3428
974.78
24.362
487.24
36.543
4175.6468

106
8730
844

170
186
84

A Draught of 14⁹² perches of land with allowance of six per cent for roads &c. situate in Cornagh Township, Allegheny County Penn^a part of a larger tract which appears to have been surveyed Oct. 24th 1767 in pursuance of an order to James Pritchard for 300^{ac} 9th 1953 dated Nov. 25th 1766. The above part Resurveyed by John Swartzel under my instructions in the fall of 1852. Examined & corrected Jan. 10th 1853.

Do J. Porter Draxley Esq.
Surveyor General of Penn^a

John Weeks C.S.

IN TESTIMONY that the above is a copy of the original remaining on file in the Department of Internal Affairs of Pennsylvania, made conformably to an Act of Assembly approved the 16th day of February, 1833, I have hereunto set my Hand and caused the Seal of said Department to be affixed at Harrisburg, this

Twenty-fifth day of June 1902.

Secretary of Internal Affairs.